

Assembly instructions for wardrobes

-

Pickawood

| ENG |

P11-1122



Preparation – Assembly	3
Preparation - small parts	4
Basic Assembly - construction outline	8
Preparing components for assembly	8
Assembly - connecting the elements	10
Assembly - adjusting and fixing	11
Assembly - installing the threaders	12
Assembly - front components	13
Assembly - adjusting and fixing - opening mechanisms	15
Assembly – drawers	16
Assembly - clothes rail / garment lift	18
Assembly – interior	18
Assembly - Vertical compartment division	19
Assembly - LED lighting	19
Assembly - belt & tie rack	20
Assembly - trouser rack	21
Assembly - clothes hanger holder	22
Assembly - notes	23

Preparation - assembly



Carefully unpack all the boxes. Sort the **individual parts** according to shape and size.

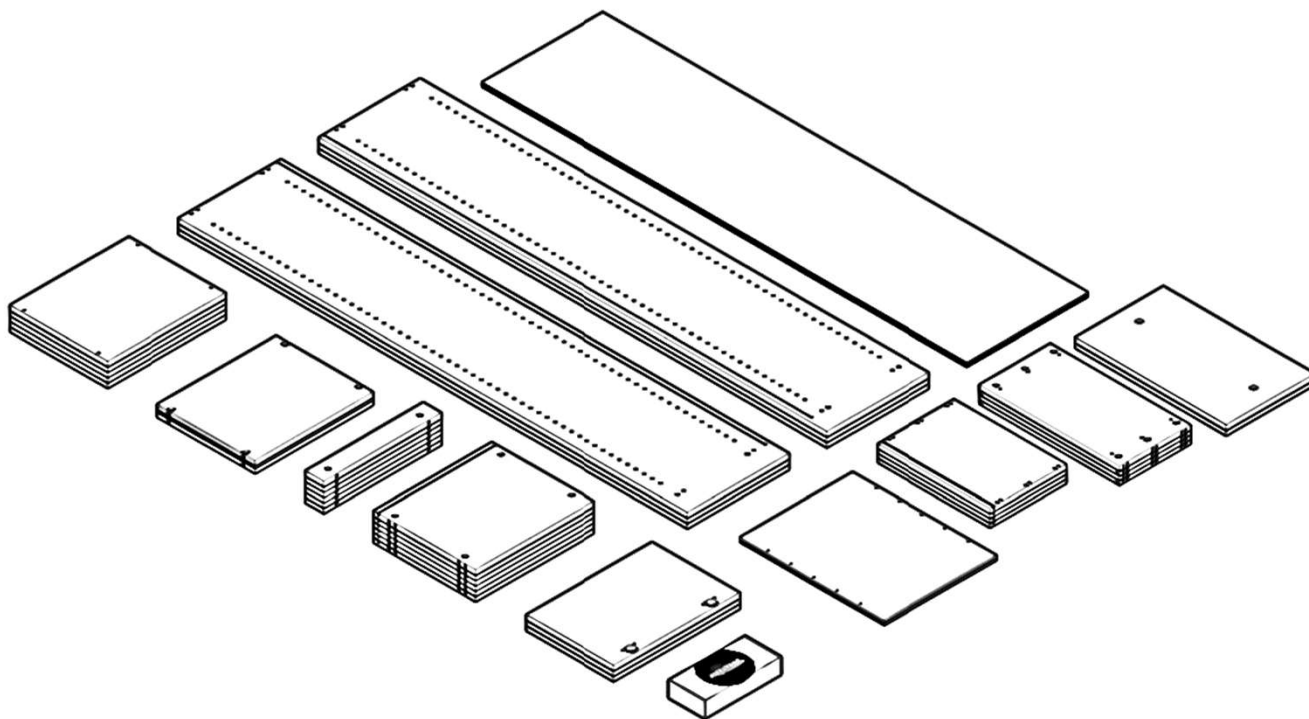

Tools - it is advisable to provide the necessary tools in advance. We recommend a hammer with a rubber head, a spirit level and a screwdriver, if available, a cordless screwdriver with the appropriate attachment (bit).

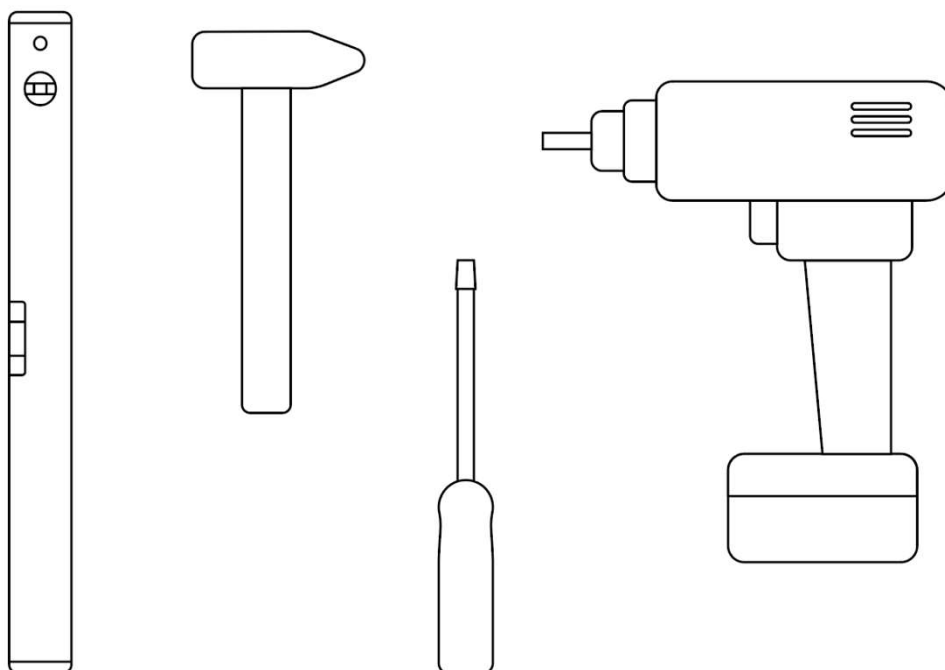

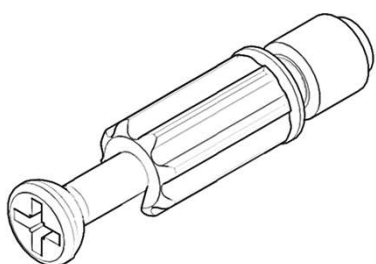

V01

Structure connector dowel
(eccentric)

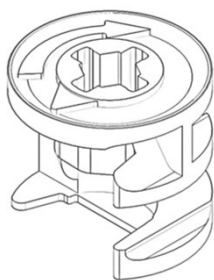

V02

Structure connector
housing (eccentric)

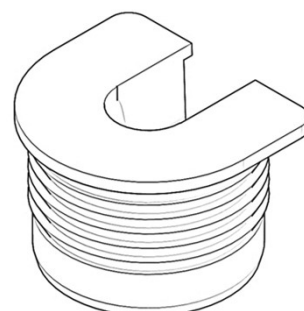

V03

Shelf connector housing

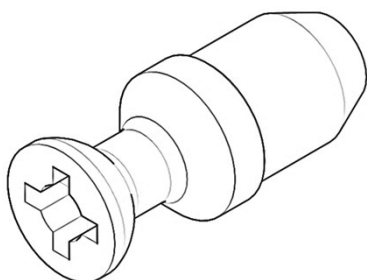

V04

Shelf connector dowel

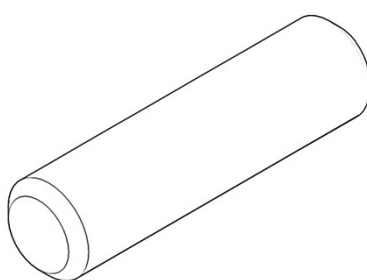

V05

Wooden dowels

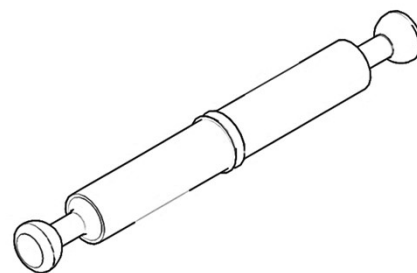

V06

Surface connector - dowel

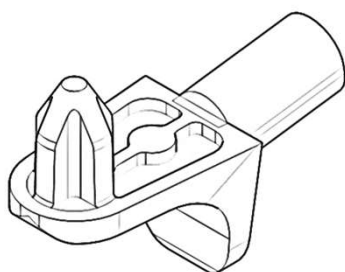

V07

Shelf connector for
mounting strip with of
holes

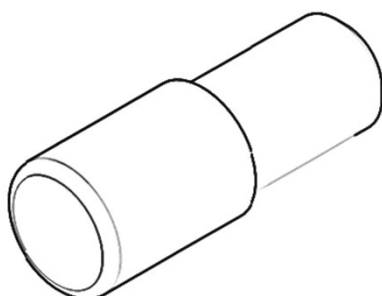

V08

Glass shelf support/ door
latch

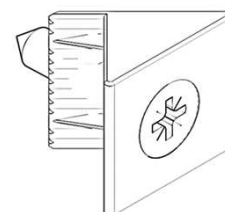

V10

Back wall panel mount

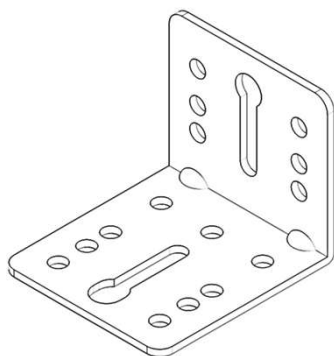

V11

Anti-tilt bracket

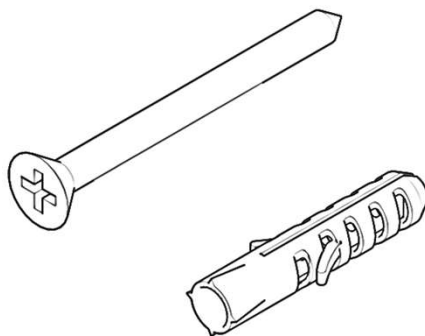

V12

Screws and dowels

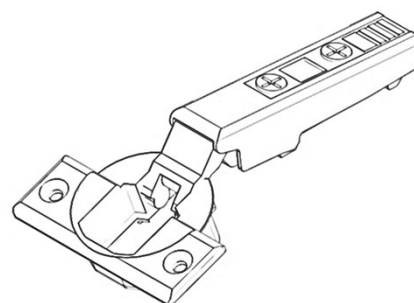

V13

Hinge

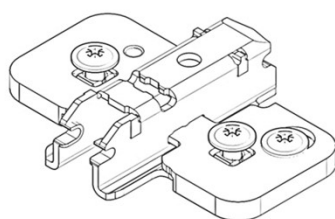

V14

Base plate - hinge support

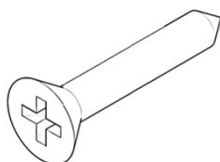

V15

Wood screw
Ø4x16 mm

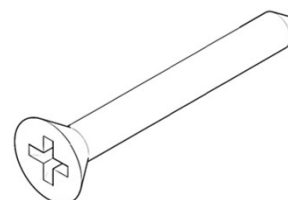

V16

Wood screw
Ø4x25 mm

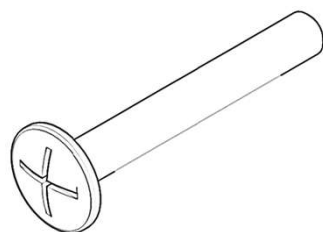

V18

M4 threaded screw

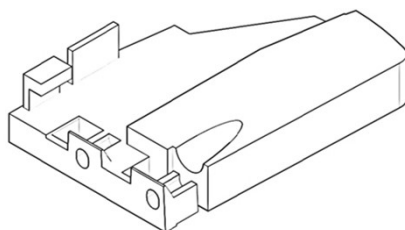

V20

Coupling drawer runner

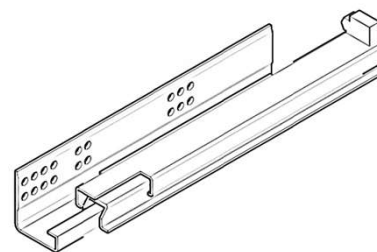

V21

Drawer runner - rail

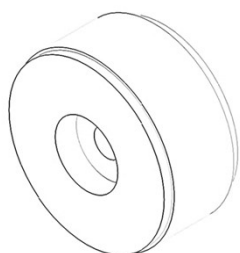

V22

Cover strip - adjustable fitting

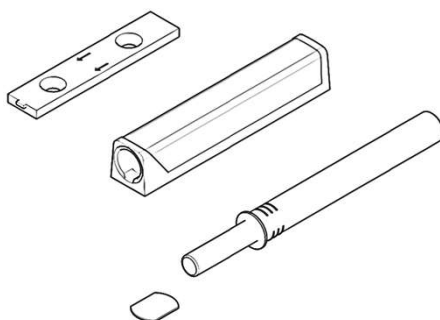

V23

Push-To-Open Set Door

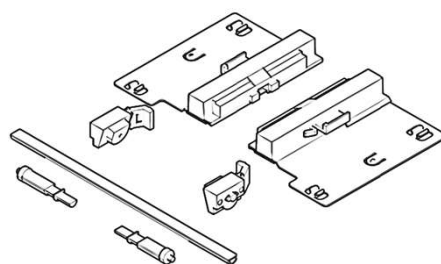

V24

Push-To-Open Set Drawer

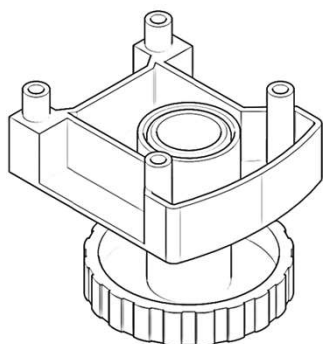

V31

Base - height adjuster

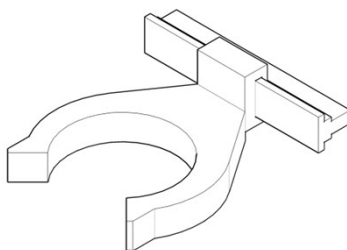

V32

Base cover clip

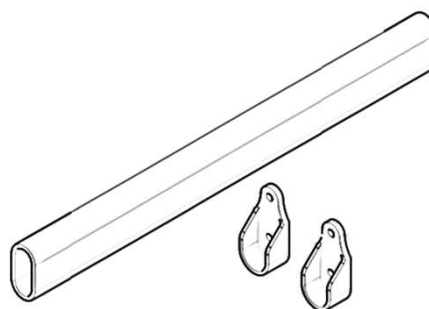

V45

Clothes rail

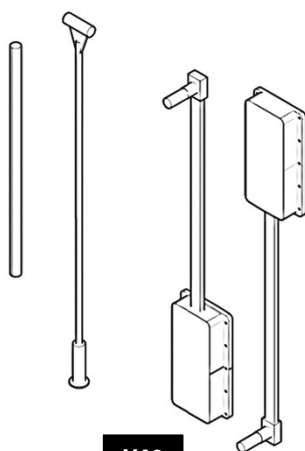

V46

Garment lift

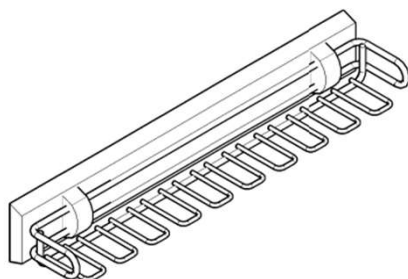

V47

Belt & tie rack

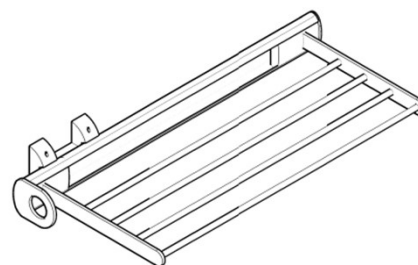

V48

Trouser rack

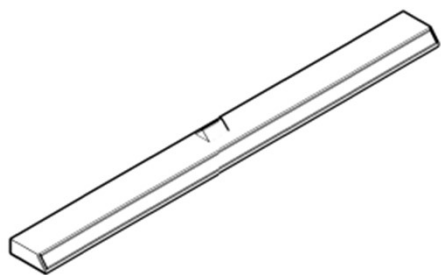

V49

Wireless LED lighting with
motion sensor

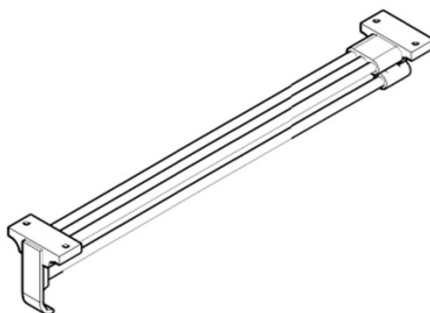

50

Extendable clothes rail

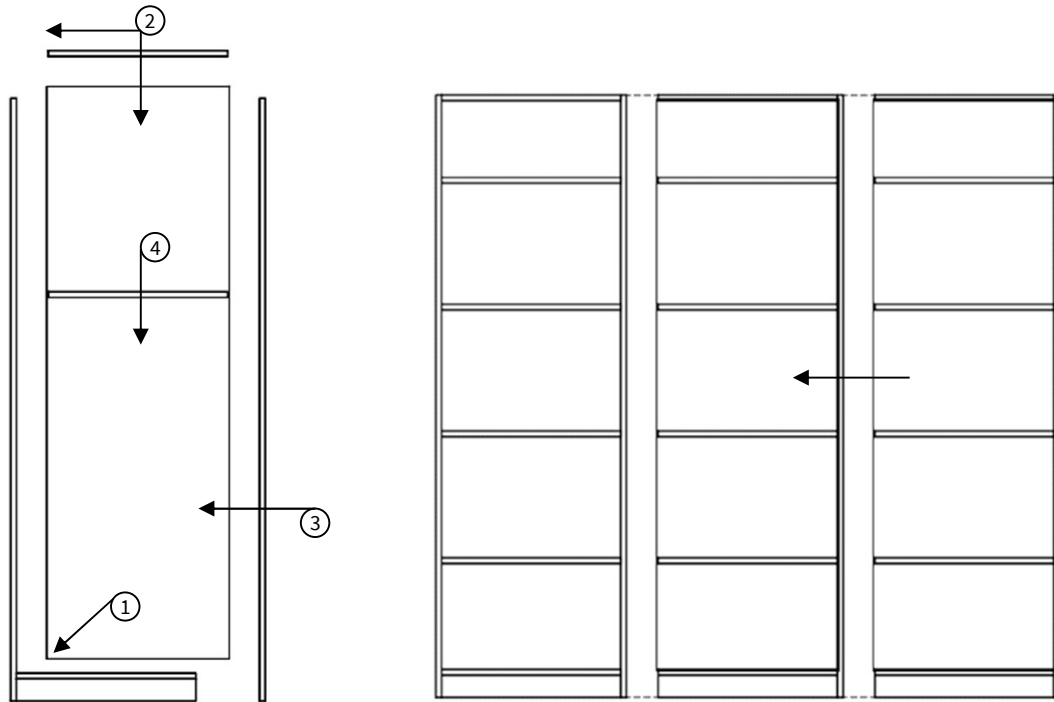

For easy **assembly**, construct the furniture from **left to right**. Start with the left outer side and connect it to the base. Assemble the furniture column by column.

Preparing components for assembly

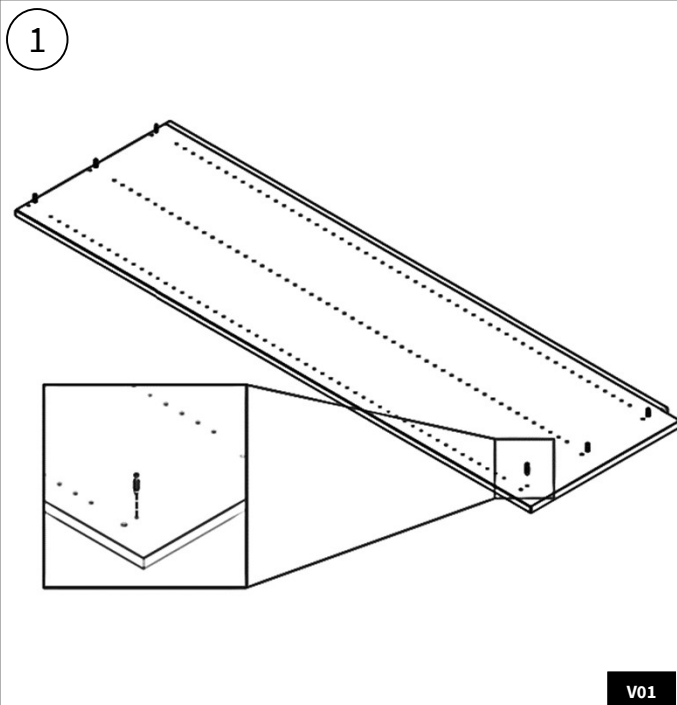

Screw the structure connector dowels (V01) into the **sides**.

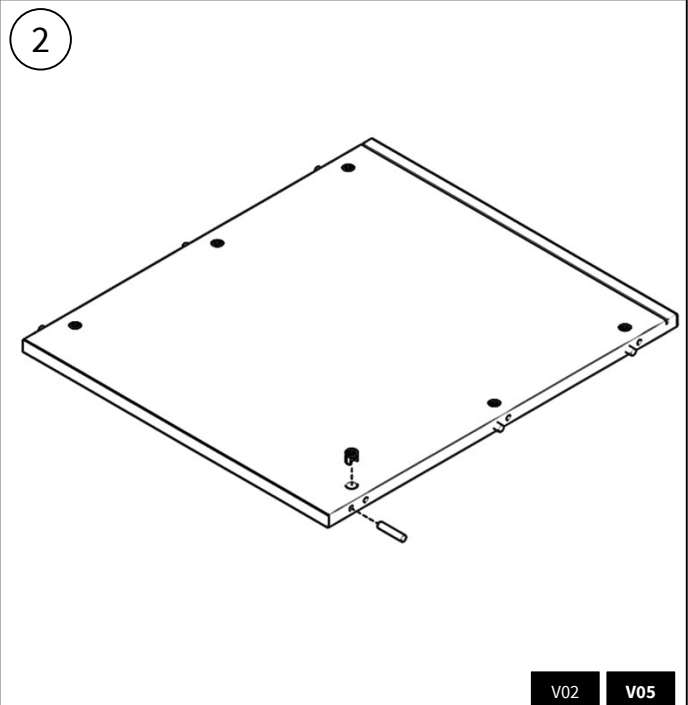

Press the structure connector housings(V02) and the wooden dowels(V05) into the **top and bottom shelves**.

3

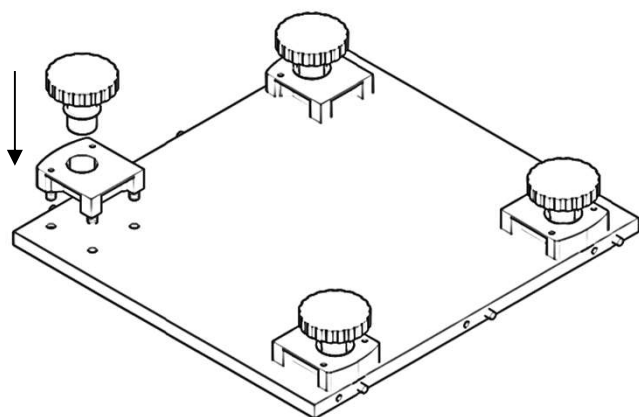

V31

Press the adapter plates and the **base feet** (V31) into the inverted base; we recommend using a hammer with a rubber head for this. **Attention:** The rounding on the adapter plates must face outwards.

4

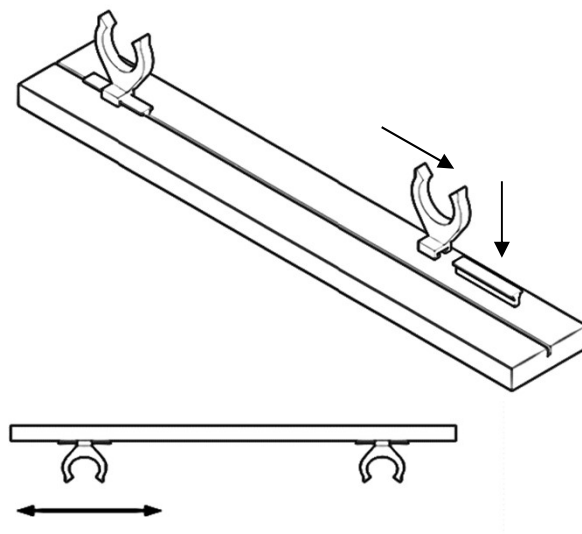

V10

A groove is provided on the base. The rail must be slid in and pushed out to install the skirting clips (V32).

5

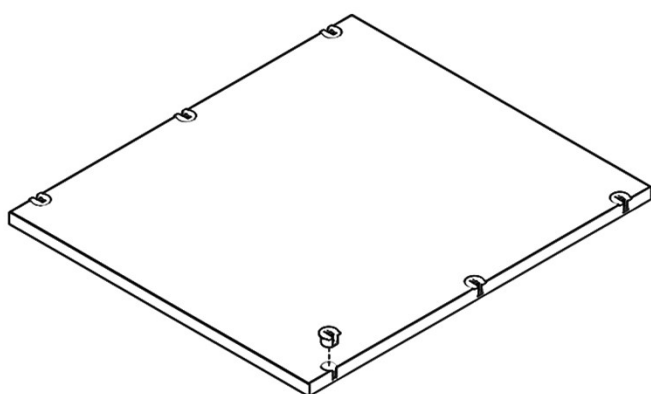

V03

You must press the shelf connector housings (V03) into the shelves. We recommend using a hammer with a rubber head for this.

6

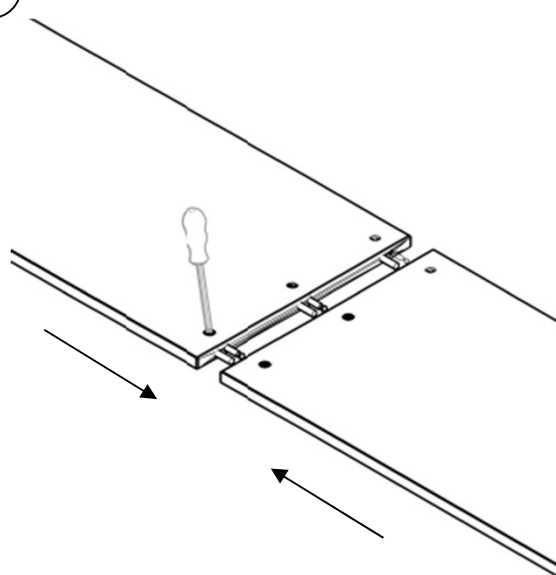

V02

V05

V06

From certain dimensions, panels can be separated into two elements and are connected with surface connectors (V06). **Important Note:** Tighten the connector housings (V02) gradually and alternately. Otherwise they may not grip properly.

1

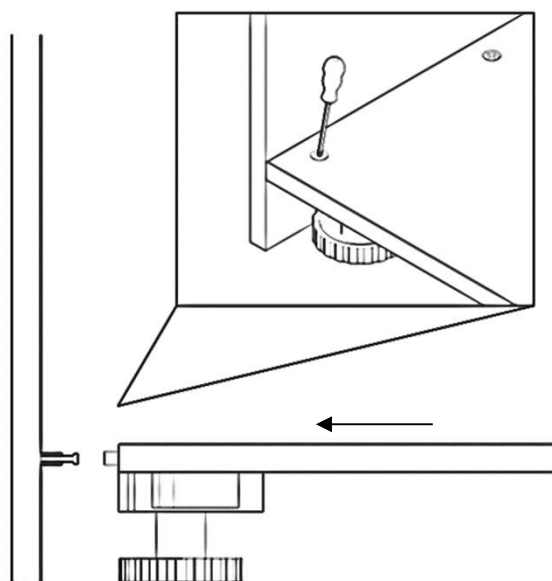

V01 V02 V05

Slide the **bottom panel** with the base feet to the left panel and fix the components by tightening the structure connector housings (V02).

2

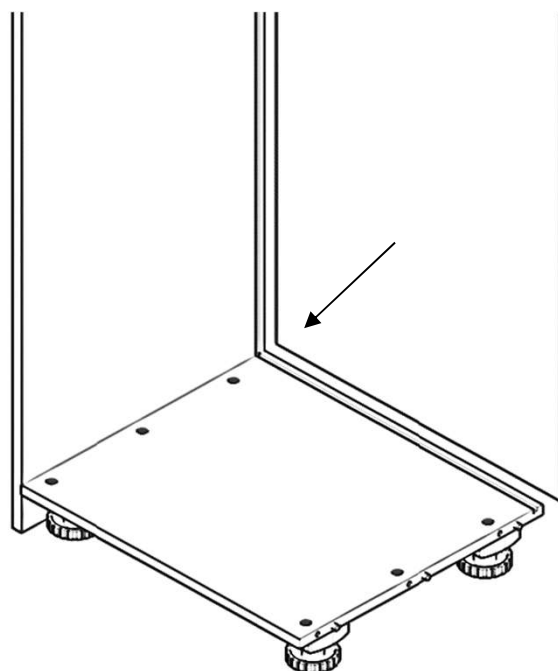

Then place the **back panel** in the grooves.

3

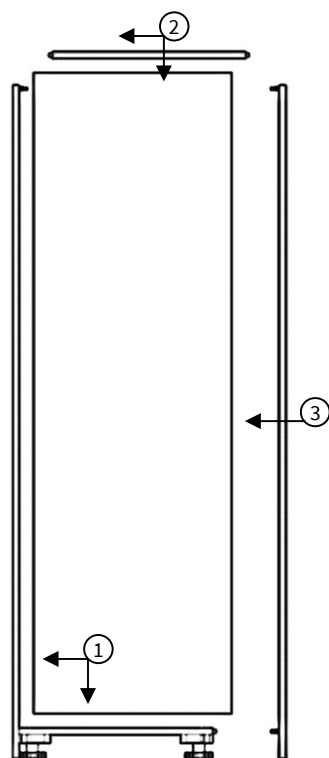

Pay attention to the correct assembly sequence. First place the back panel in the groove of the left panel and the bottom panel, then the top panel and finally the right panel.

4

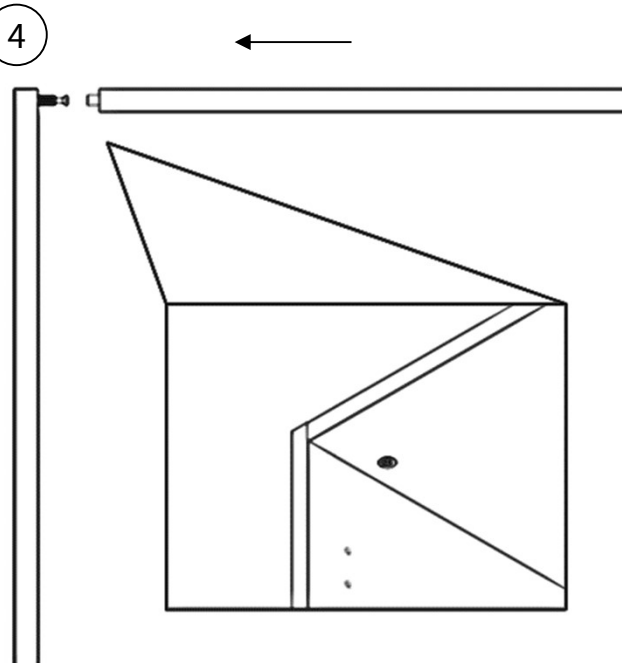

V01 V02 V05

Slide the **top shelf** in place and fix the structure connector housings (V02).

Assembly - connecting the elements



5

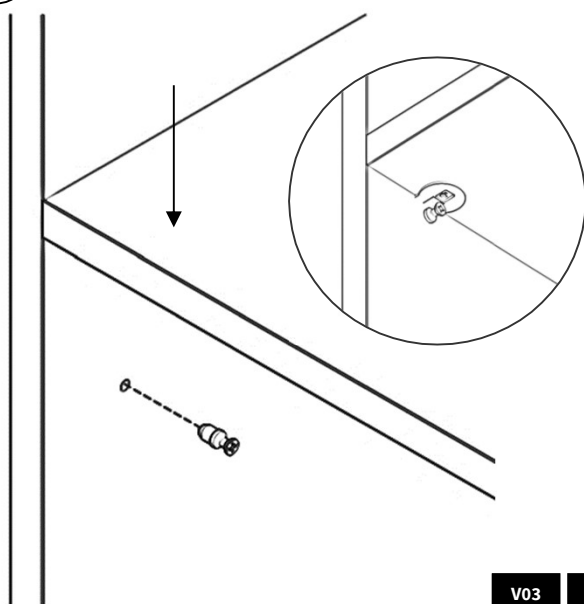

V03 V04

To insert the **shelves**, screw the shelf connector dowels (V04) into the stringers and slide the shelf onto them from above. Then fix the shelf connector housings (V03).

6

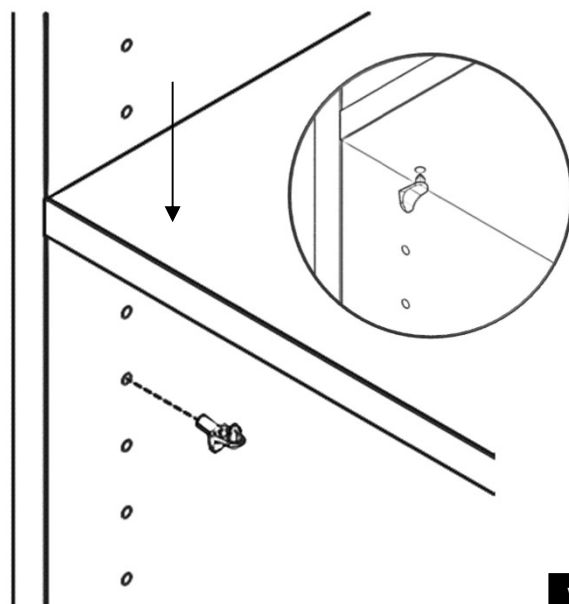

V07

To insert **shelves** into a **mounting strip with holes**, insert the shelf support (V07) into the stringers and slide the shelf on from above.
Important note: One shelf must be fixed per column (as in step 5) so that your furniture has sufficient stability.

Assembly - adjusting and fixing

1

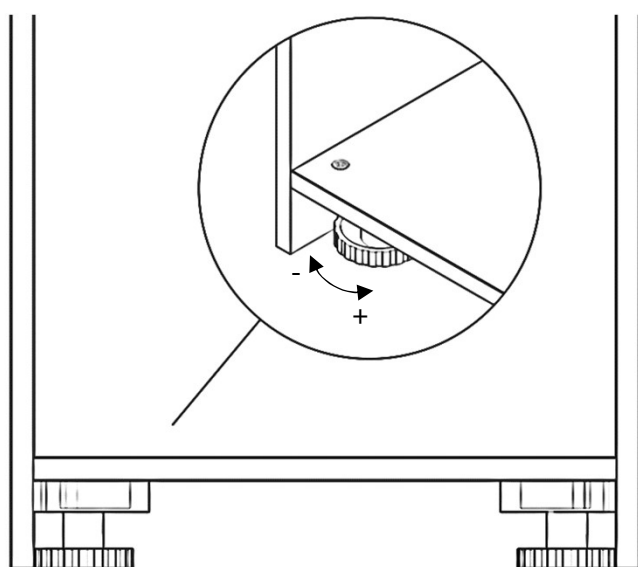

V31

Align your furniture with the help of a spirit level. To do this, turn the plinth feet (V31) in and out.

2

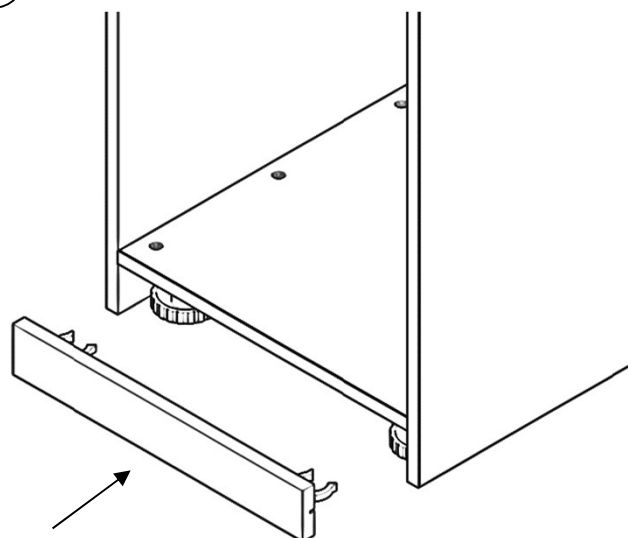

V31 V32

After the furniture is level, slide the **base panel with the clips** (V32) onto the **base feet** (V31).

Assembly - adjusting and fixing



3

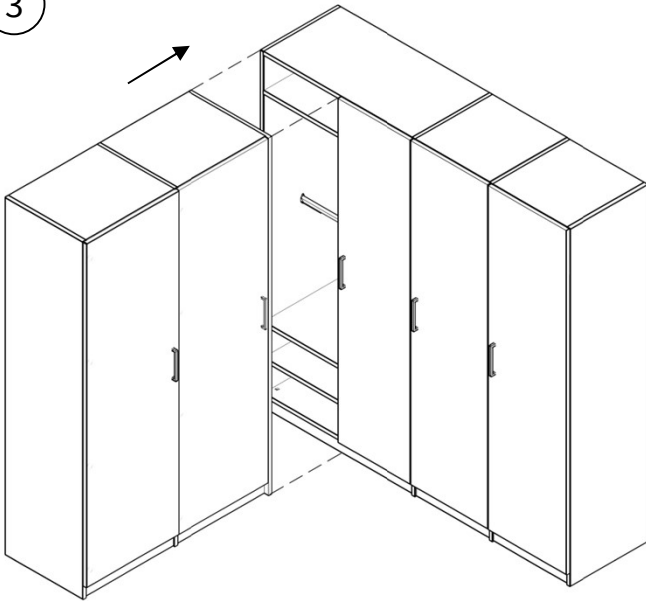

For **corner wardrobes**, it is important to install one after the other. Start with the wardrobe that is to be placed in the corner and then install the one that is to be placed next to it. After assembly, you can connect the two structures with dowels and connectors.

4

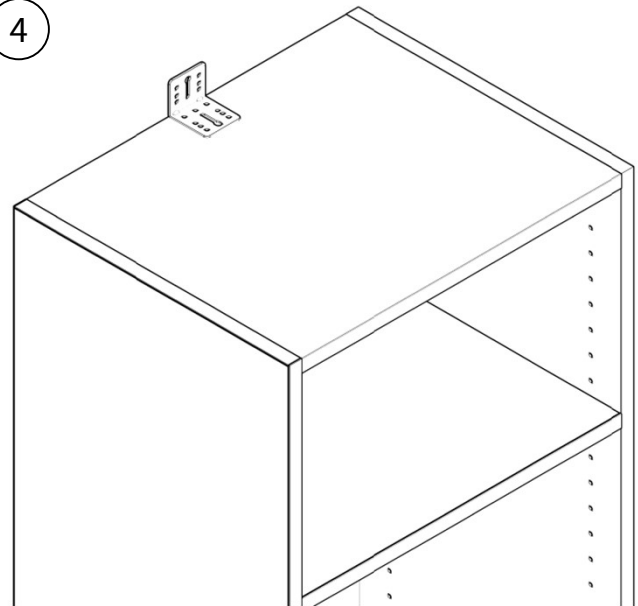

V11 V12 V15

Once you have stabilised and leveled the furniture, attach it to the wall using the **anti-tip brackets** (V11). Use the screws for the furniture (V15) and the screws for the wall (V12) for this purpose.

Assembly - cover strips

1

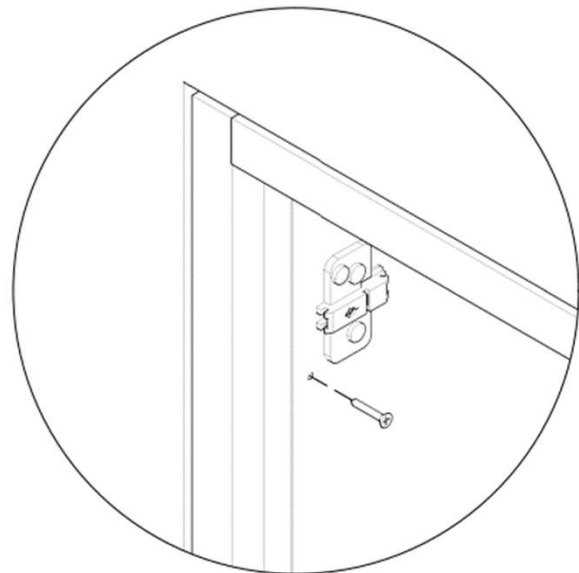
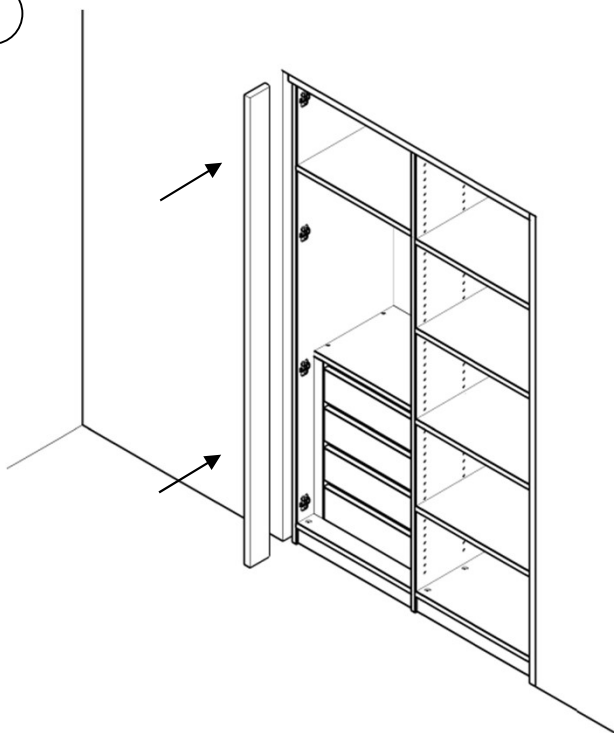

V16

Place the **cover strip** in the space between the furniture and the wall. Then drill and screw the cover strips from the inside. Use wood screws (V15) for this.

Attention: The screw heads are visible from the inside afterwards, if possible place the screws in inconspicuous places, for example at the top of a shelf.

1

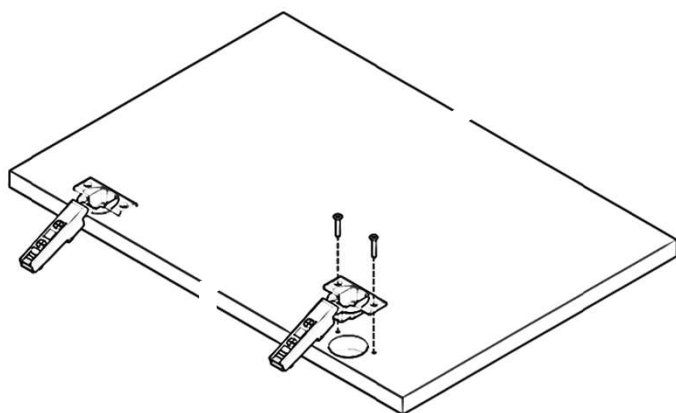

V13

V15

For **doors and flaps**, insert the hinges (V13) and screw (V15) them in place.

Corner hinge

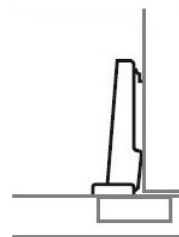

Central panel hinge

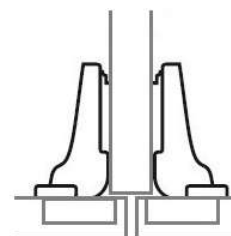

Interior hinge

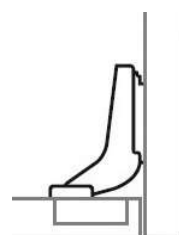

When actioning this, make sure to choose the right **hinges**. Match the mounting positions of the fronts.

2

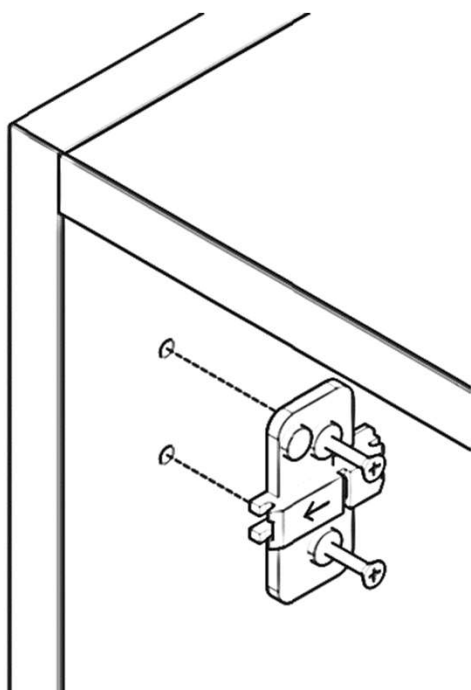

V14

Insert the **mounting plates** (V14) with the arrow pointing forwards and fasten them by fixing the screws.

3

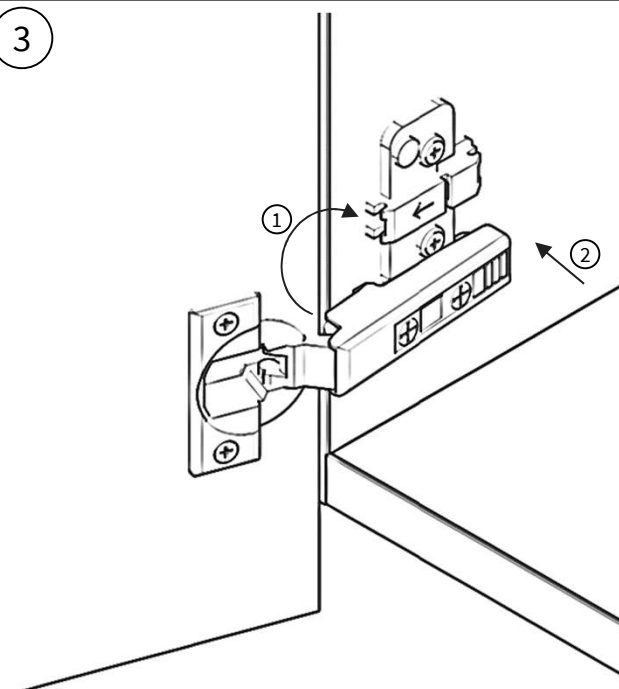

V13

V14

First place the hinges (V13) on the front edge of the mounting plate (V14). Then press the hinges firmly at the rear until the hinge engages.

4

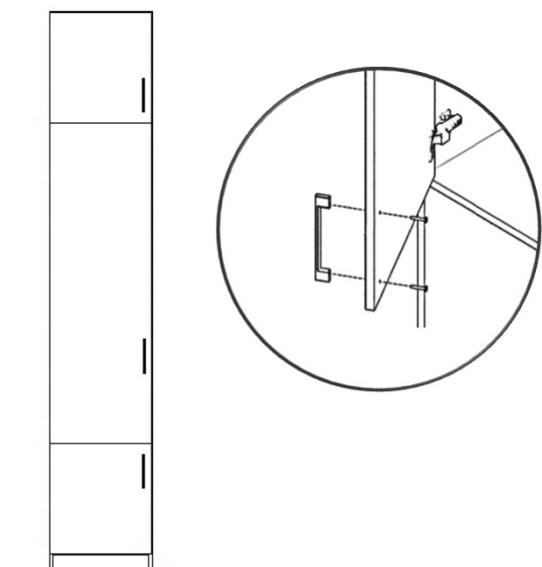

V17

Fasten the **handles** to the doors through the pre-drilled holes using the enclosed M4 screws (V18). **Important Note:** Use the shorter version of the screws (V18) for glass doors.

5

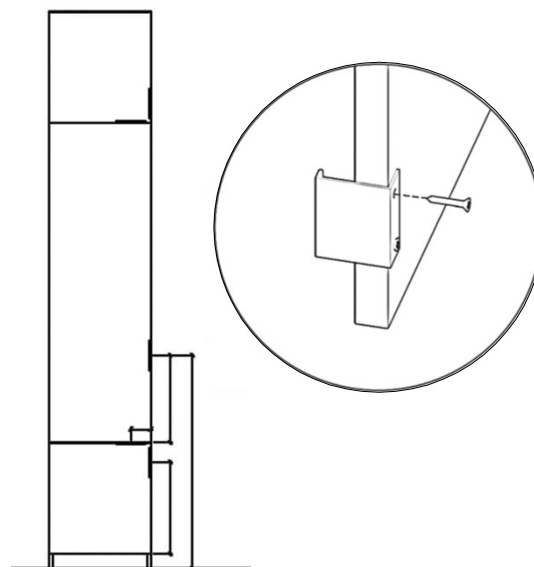

For **handles 2 or 3**, you can determine the position for yourself. Screw them in place at the back using the screws provided. The handles can also be mounted horizontally.

6

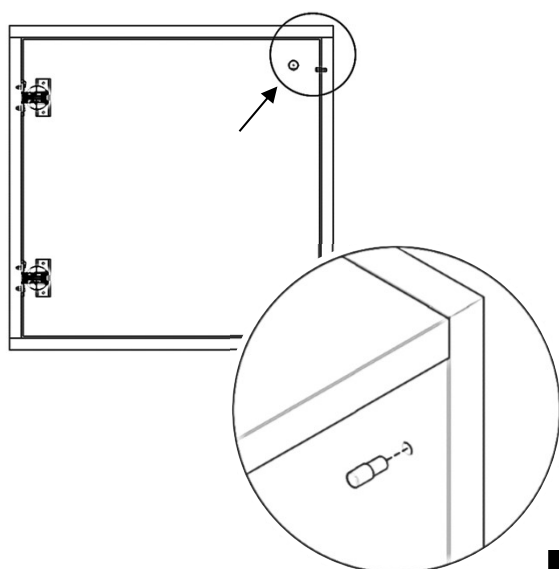

V08

For **interior doors with a handle**, stop buffers (V08) are enclosed. Press them into the pilot holes.

Note: In the case of hinged doors, the stop buffers are fitted at the bottom edge of the door.

7

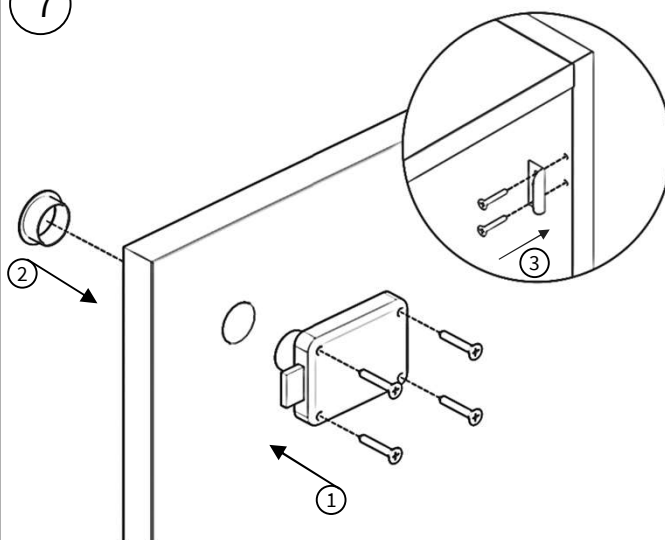

V18

Furniture locks (V19) are pressed into the hole from behind and screwed into place. Press the key rosette from the front and then screw the locking bracket to the stringers or the shelf.

Note: For hinged doors, screw the striker bar to the opposite door.

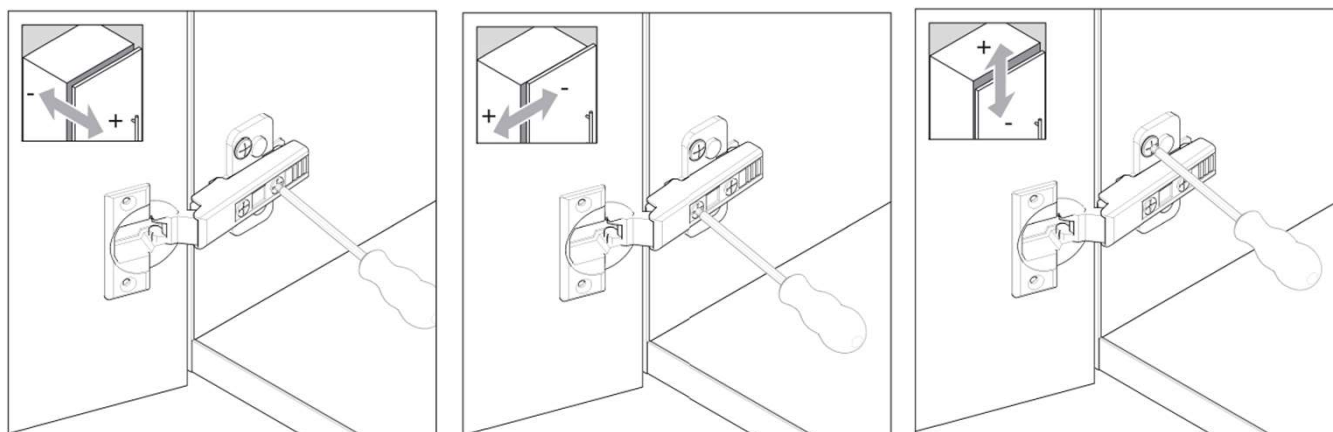

+3 / -2 mm

+/- 2 mm

max. +/- 3mm

V13

V14

To **adjust the doors** on your furniture, you can set the adjustment options on the hinges (V13) and the mounting plates (V14).

Note: Start with a front that you align to a stringer and adjust the other fronts to it.

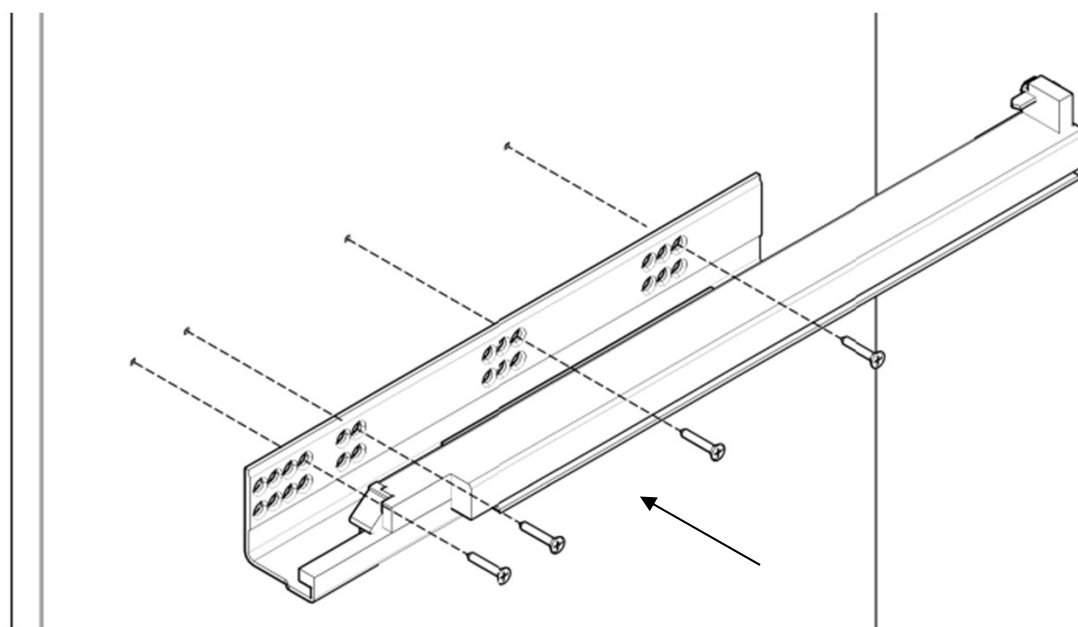

V15

V21

Screw the **drawer runners** (V21) to the side panels of the furniture with the wood screws (V15). Use the first upper hole of the rails for the first hole in the item. The other fastening points can be found in the pre-drilled holes in the side panels.

1

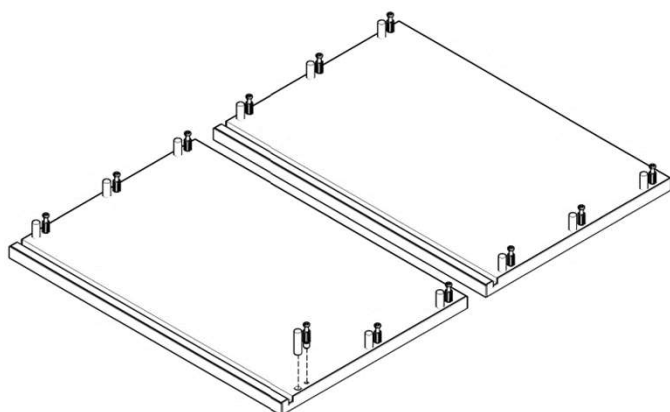

V01

V05

Place the **drawer sides** in front of you and screw in the eccentric screws (V01) and then press in the dowels (V05).

2

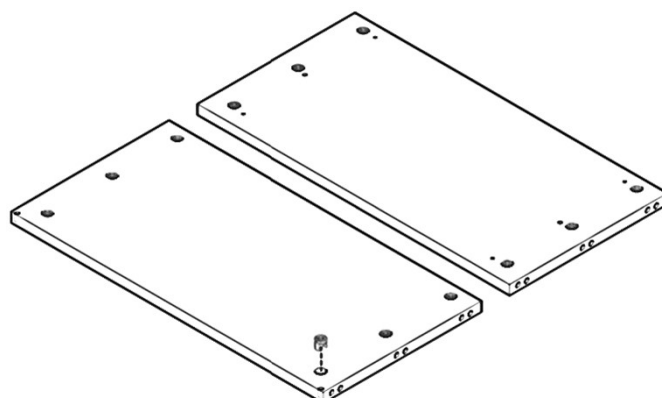

V02

Press the eccentric housings (V02) into the **front and rear panels**. Make sure that the open side and the arrows point outwards.

3

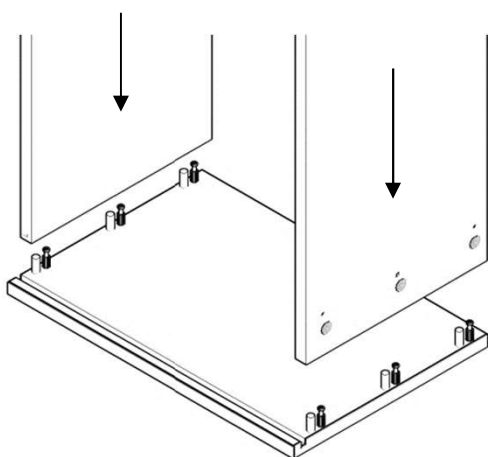

V01

V02

Connect the front and back to the side panels. Then fix the housings (V02) by turning them 180° with a screwdriver.

4

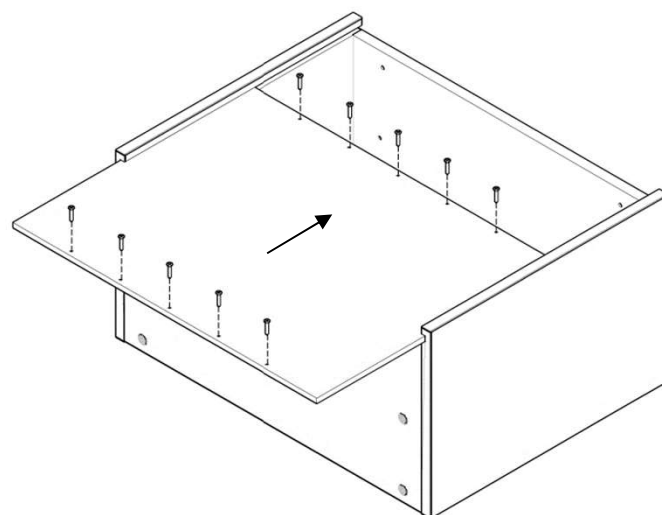

V16

Slide in the base. Ensure the base is aligned with the front edge of the drawer and fix it with the screws (V16).



5

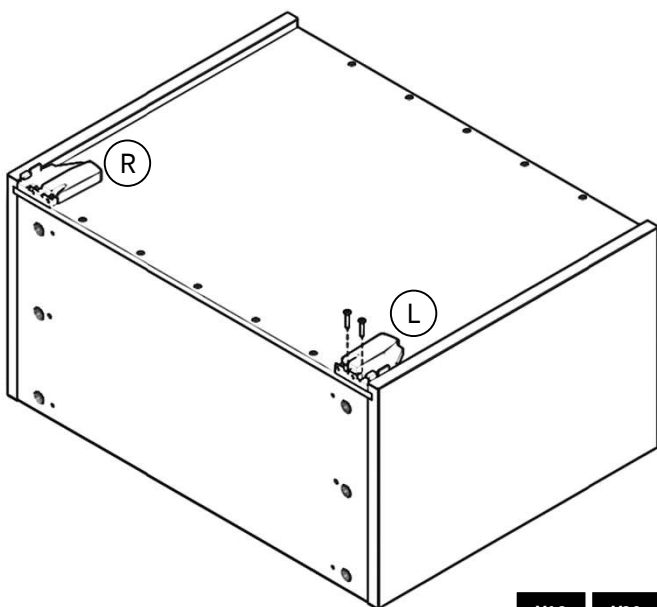

V16 V20

The couplings (V20) are labelled R and L. When screwing on the couplings, make sure that they are aligned with the front edge. You can recognise the front edge by the additional holes.

6

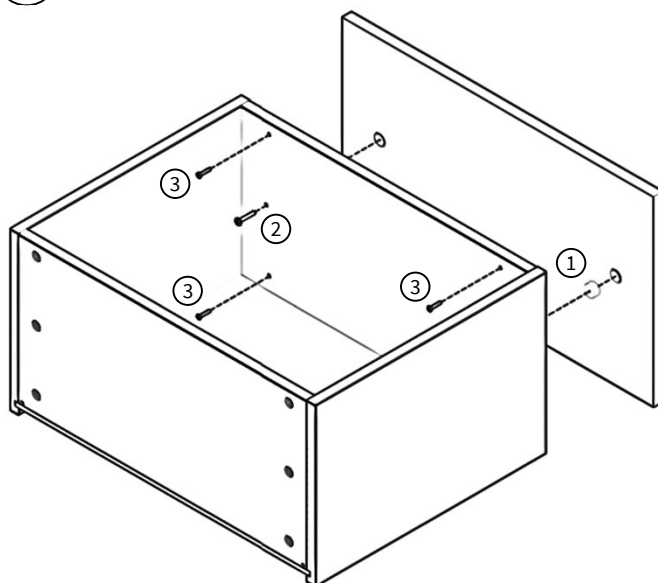

V22 V18 V16

1. Install the adjustment fittings (V22) in the front panel.
2. Use the screws (V18) to connect the front panel.

7

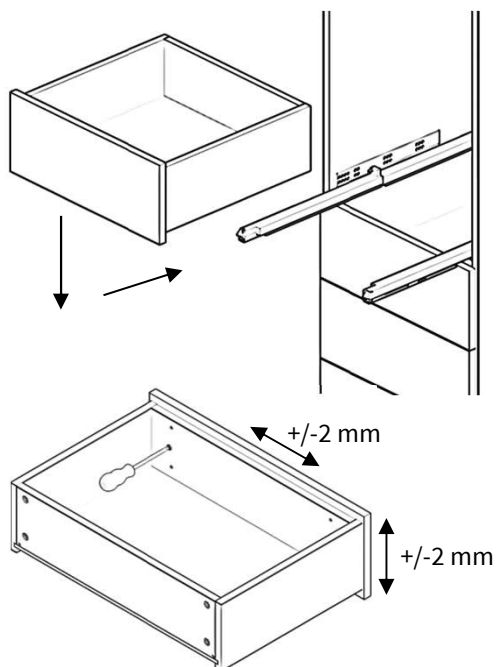

V18

Insert the drawer into the furniture structure. You can now adjust the front panel: loosen the screws (V18) a little to move and adjust the front panel.

3. Use the screws (V16) to consolidate the assembly (see picture).

8

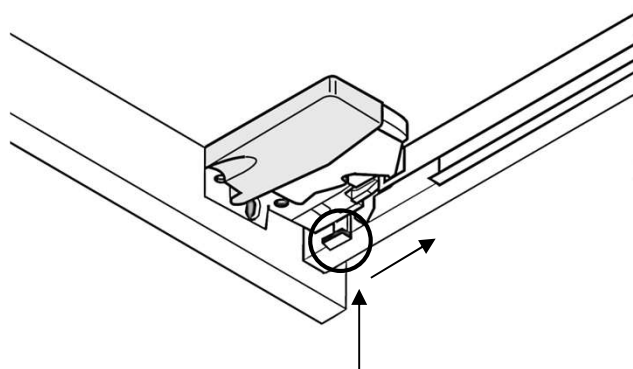

V20

To then adjust the height of the drawer, push the control on the drawer coupling (V20) forwards or backwards.

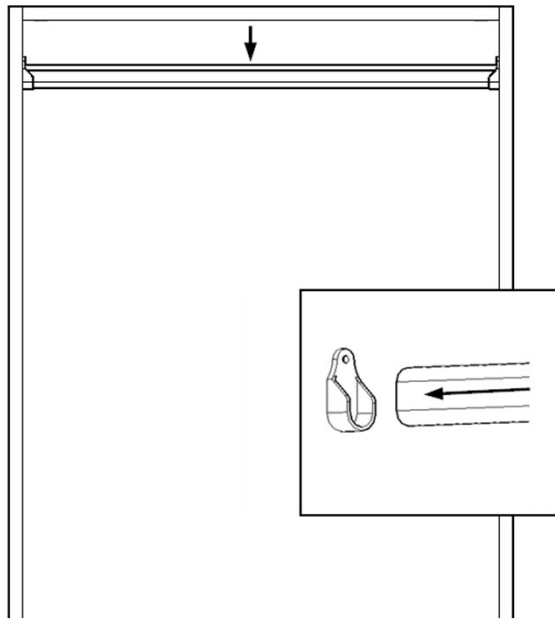

V45

Fix the **clothes rail brackets** in the holes provided, then hang the clothes rail.

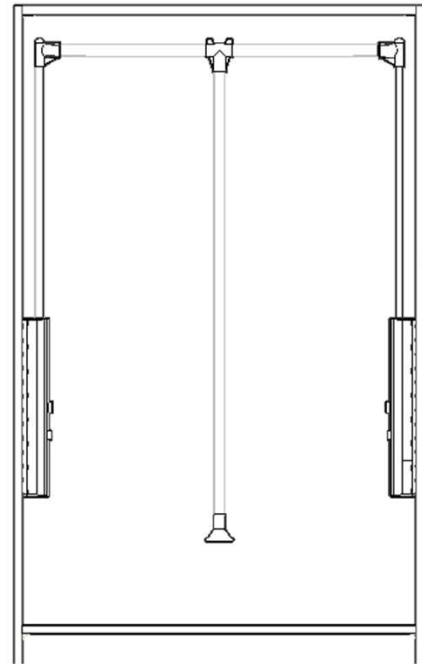

V46

Fasten the side arms into the pre-drilled holes with the screws provided, then place the clothes rail between the arms. Important Note: Fold out the arms to make it easier to insert the rod.

Assembly - interior drawer

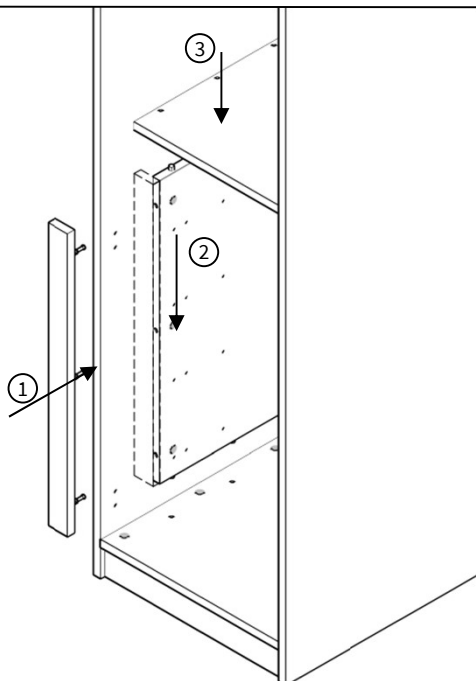

To fit the **interior drawers**, first, insert the adjustment sides including the panels. Then position the top shelf.

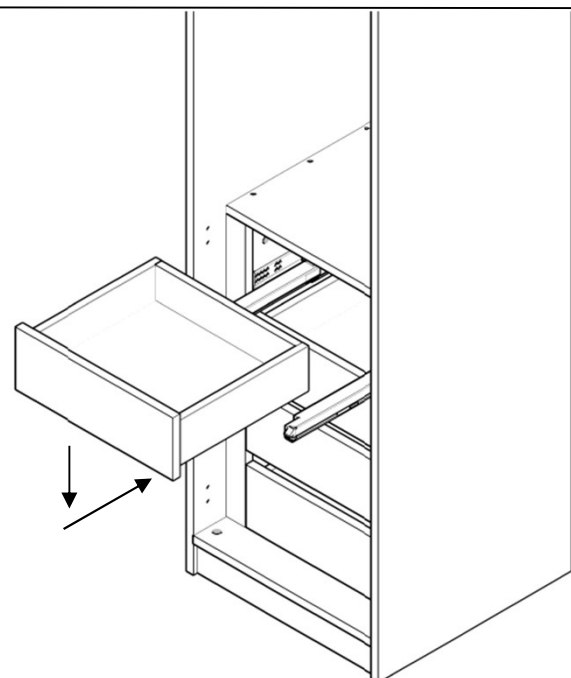

Next insert the drawers.
Note: The recess and the panel enable the drawers to be opened without restriction, without bumping against the door or the hinges.

Assembly - vertical division

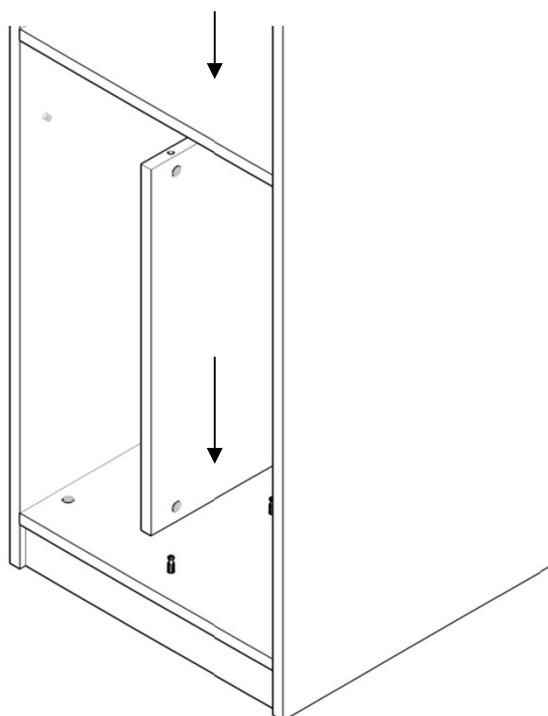

V01

V02

Vertical compartments are fixed with structure connectors. It is important here that the shelves are inserted correctly above and below. The structure connector dowels (V01) must be screwed in here. The connector housings (V02) must be inserted into the vertical dividing board and the whole assembly must be secured by pushing the two shelves together

Assembly - battery light

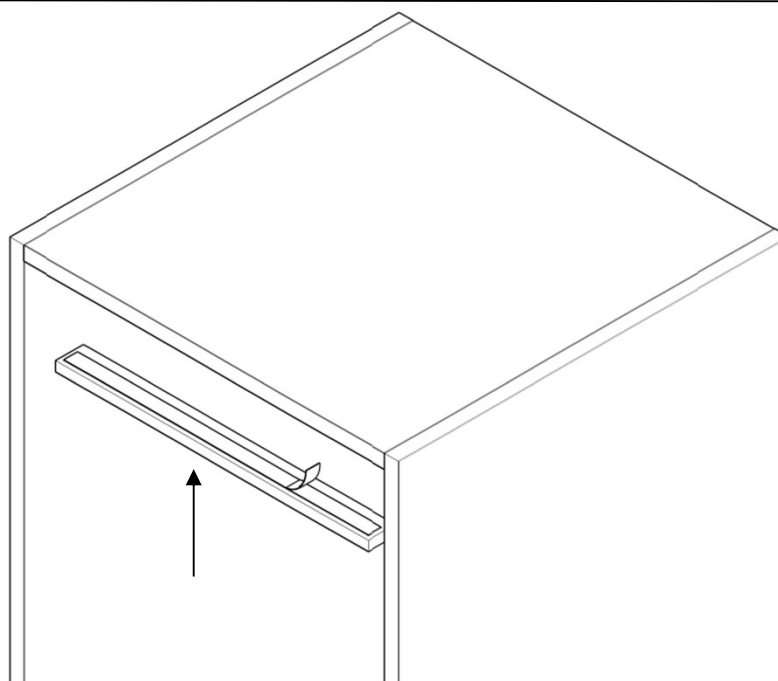

V49

The **LED battery strips** are fixed without screws or fasteners. There is a self-adhesive magnetic tape on the top of the LED strips. For mounting, it is easiest to leave it on the LED strip. Measure the distance from the LED strip to the front edge of the shelf and the centre of the shelf. Then peel off the adhesive protector and press the LED strip against the shelf.

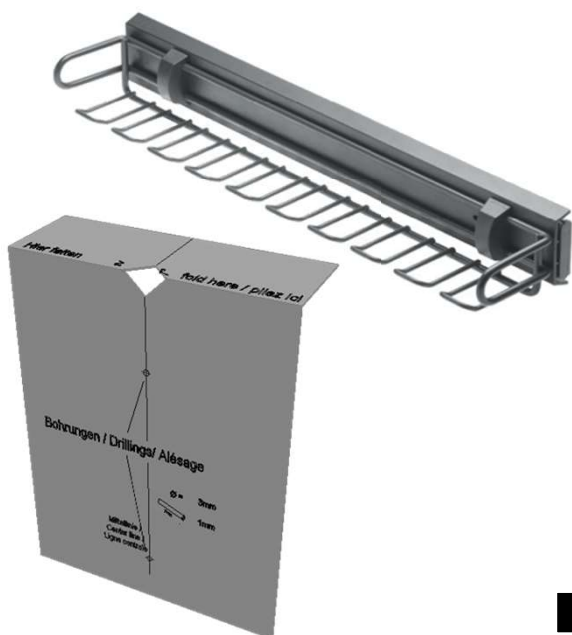

The assembly is carried out using the **drilling template** supplied. Fold it at the folded edge and cut out the rhombus.

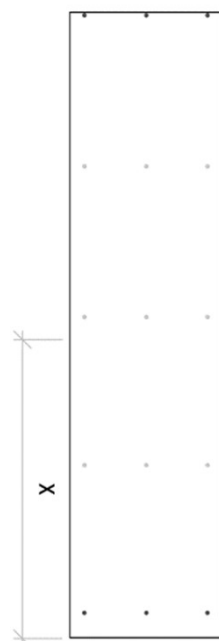

Place the side of the furniture where the bracket is to be mounted in front of you and mark the position in height on the front edge. We recommend a minimum distance of 60 cm to the floor below and at least 5 cm to the shelf above.

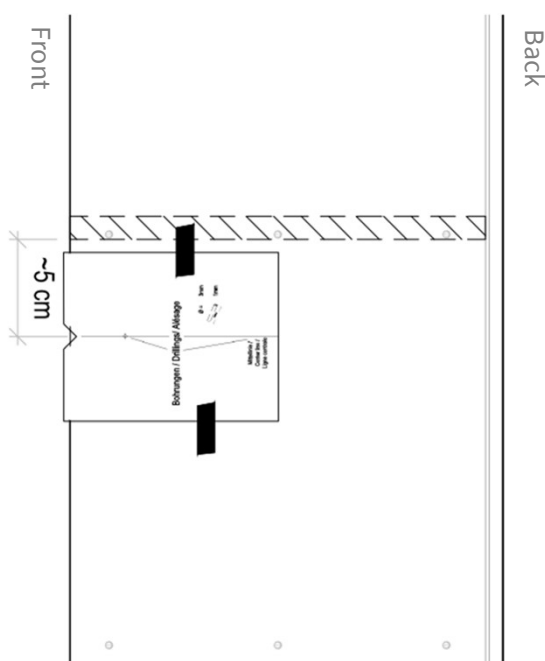

Place the drilling template with the folded edge against the front edge of the floor and then push it to your mark. Fix the template with adhesive tape and drill through it.

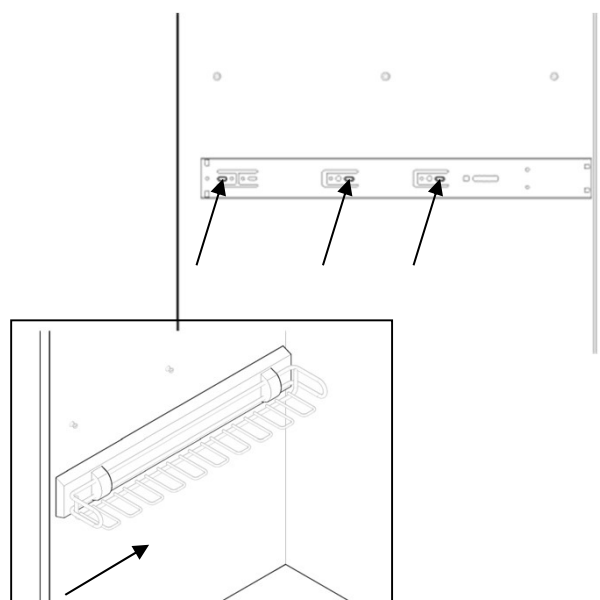

To fix the bracket, remove the extendable part of the bracket and screw into the holes indicated on the rail. The drilling template only shows the first two drill holes. The other holes can be drilled through the rail using the marking shown. Finally, clip the extendable part of the bracket back on.



V48

The assembly is carried out using the **drilling template** supplied. Fold it at the folded edge and cut out the rhombus.

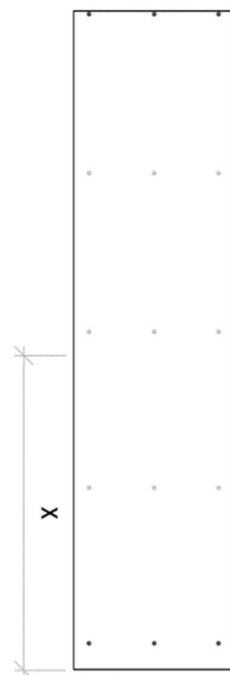

Place the side of the furniture where the bracket is to be mounted in front of you and mark the position in height on the front edge. We recommend a minimum distance of 60 cm to the floor below and at least 5 cm to the shelf above.

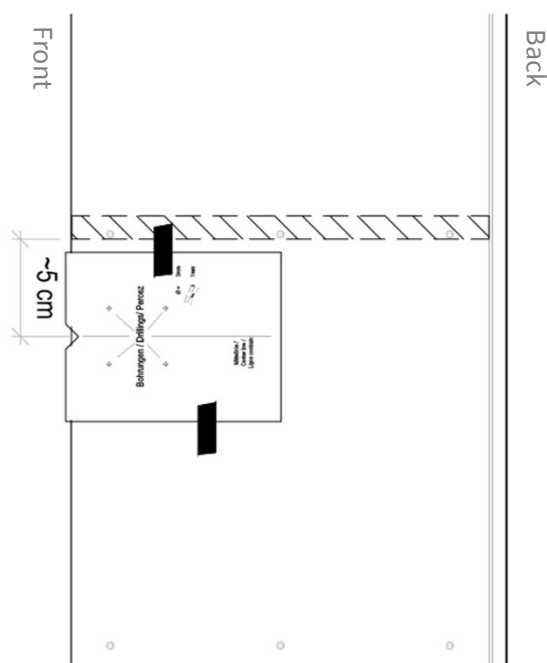

Place the drilling template with the folded edge against the front edge of the floor and then push it to your mark. Fix the template with adhesive tape and drill through it.

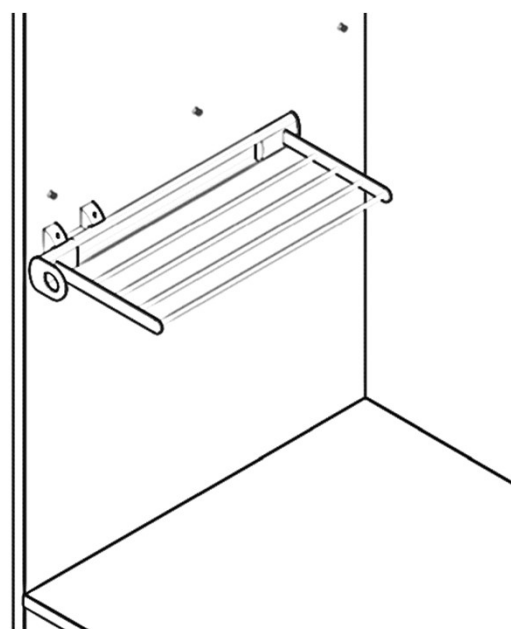

Finally, you can fix the bracket with the screws provided.

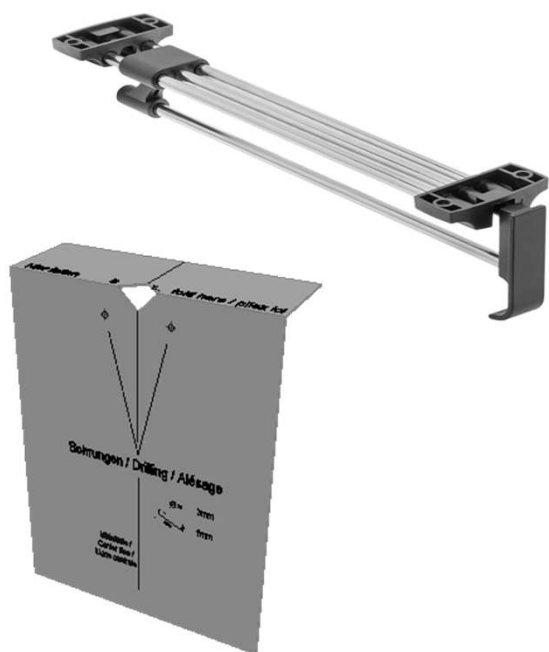

V50

You carry out the assembly with the **drilling template** supplied. Fold it at the folded edge and cut out the rhombus.

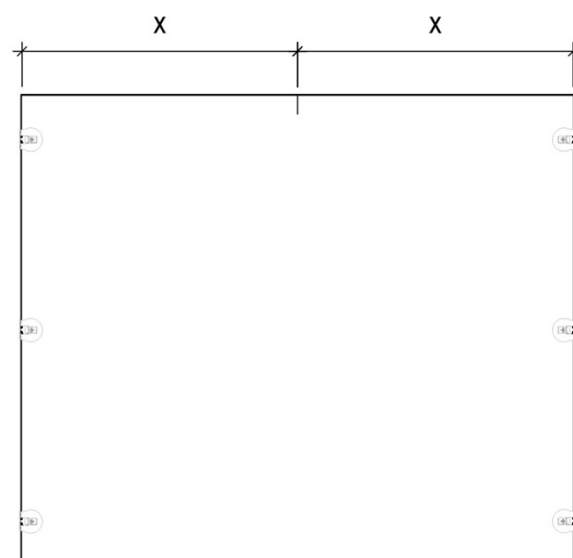

Position the panel on which the bracket is to be installed in front of you, then mark the middle of the panel on the edge (see picture)

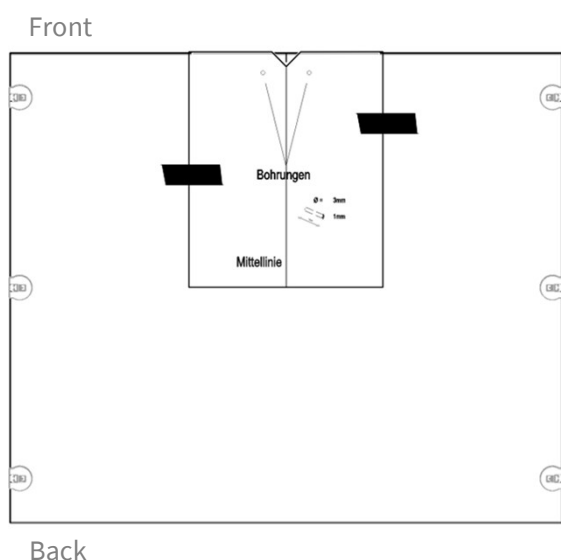

Place the drilling template with the folded edge against the front edge of the floor and then push it to your mark. Fix the template with adhesive tape and drill through it.

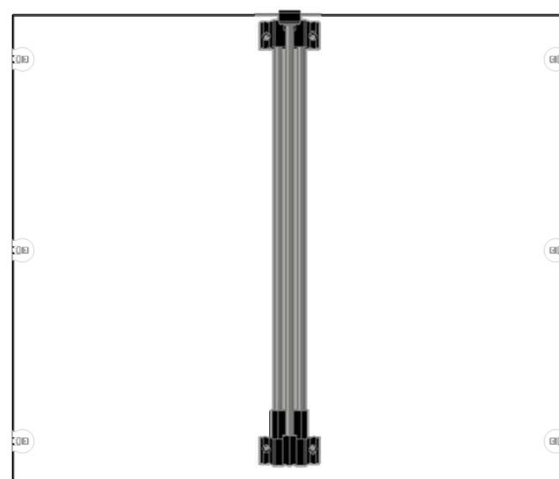

Lastly, you can fix the pull-out by the front screws, then align and fix the pull-out at the back.





Book assembly service
retrospectively:



www.pickawood.com/en/advice-service/montage

If you have any questions, you can reach us via
email or telephone. We will be happy to help you!



Mail: support@pickawood.com

Telefon: 0330 808 4870

Web: www.pickawood.com

Amsinckstraße 34, 20097 Hamburg, Germany